



P.O. Box 596, 105 Main Street S, Grand Meadow, MN 55936
Bus: 507-754-5815 • Toll Free: 800-658-2340 • www.lrmrealestate.com

• Farm Management • Real Estate • Market Analysis

Dexter 111 Farm

Approximately 111.83 Acres Mower County Farmland.

Total Acres: 111.83 approximately
Tillable Acres: 103.91 approximately
Prodex: 86.5
Improvements: Pattern Tiled
Taxes: \$6.586 Ag Non-Homestead (2025)
Price: \$1,350,000.00
Legal Description: 33 103 016 E1/2 SW1/4 & N1/2 W1/2 SW1/4 EXC 8.17 AC HWY W1/2 SW1/4
Note: Good tenant in place for 2026 crop year

LAND RESOURCE MANAGEMENT & REALTY, INC.

Randy Queensland, Broker
randy@lrmrealestate.com
Office: 507-754-5815
Cell: 507-273-3890

Ryan Queensland, Broker
ryan@lrmrealestate.com
Office: 507-754-5815
Cell: 507-273-3000

Information is from sources deemed reliable but is not guaranteed by agent

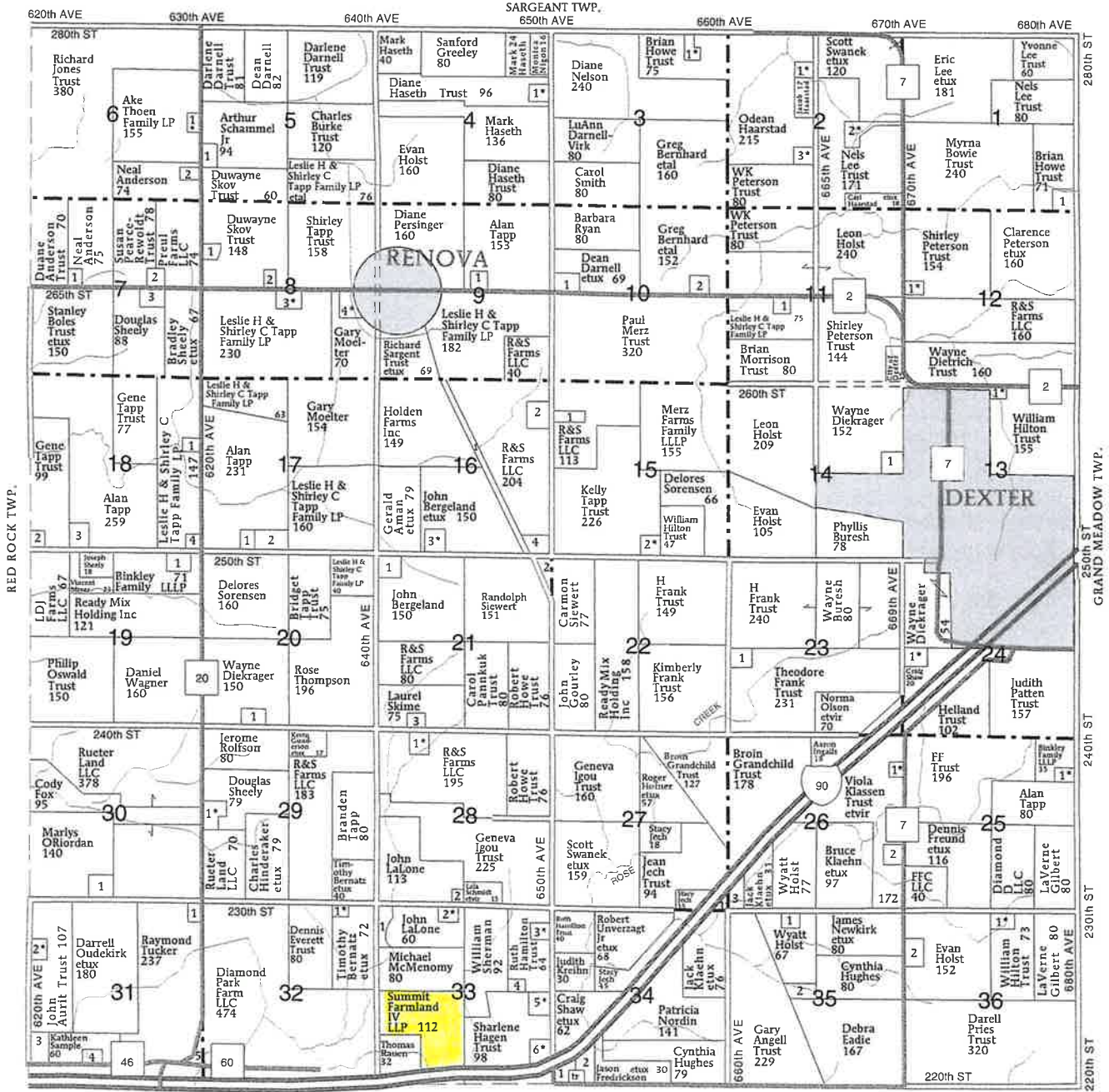

MARSHALL TWP.

DEXTER TOWNSHIP	
SECTION 1	1
1 HOWE FARMS LLC	10
SECTION 2	1
1 MORTENSON, KEVIN ETUX	7
2 LEE, ERIC ETUX	10
3 SHULZE, STEVEN ETUX	5
SECTION 3	1
1 MACHACEK, STEVEN ETUX	6
SECTION 4	1
1 SHERMAN, MATTHEW ETUX	7
SECTION 5	1
1 WINSKY, NICHOLAS	6
SECTION 6	1
1 UNVERZAGT, RICHARD ETUX	5
2 BORCHERING, JONATHAN	6
SECTION 7	1
1 VANBUSKIRK, DYLAN	6
2 VANBUSKIRK, DYLAN	9
3 MELDAHL, BRIAN	5
SECTION 8	1
1 VANBUSKIRK, STEVEN	8
2 ANDERSON, NEAL	10
3 DRAKE-TAPP, DARCY ETAL	10
4 SARGENT TRUST, RICHARD O ETUX	10

SECTION 9	
1 TAPP TRUST, KELLY	5
SECTION 10	1
1 HOFFMAN, LYNN	11
2 R&S FARMS LLC	8
SECTION 11	1
1 LINARUCCI, CHRISTOPHER	5
SECTION 12	1
1 MINEAR, NATHAN ETUX	7
SECTION 13	1
1 O'CONNELL, JOHN ETUX	6
SECTION 14	1
1 LONERGAN TRUST, ROBERT	9
SECTION 15	1
1 BARNEY, BRYCE	7
2 GRUHLKE, JASON ETUX	8
SECTION 16	1
1 HOWE, BART	14
2 D&H LLC	13
3 ALLEN, DAVID ETUX	7
4 HOLST, LEON	10
SECTION 17	1
1 TAPP TRUST, DELMAR	6
2 TAPP, DELMAR	14

SECTION 18	
1 TAPP, MICHAEL	5
2 GAREY, HEATH	6
3 DRAKE, JANICE	10
4 RICHARDSON, WYATT	5
SECTION 19	1
1 HOPPE, DIANE	9
SECTION 20	1
1 DOBBS, NICHOLAS	6
SECTION 21	1
1 JACOBS, HAYLEY	10
2 SIEWERT, CARMON	12
3 TAPP TRUST, KELLY	5
SECTION 23	1
1 FOUR F FAMILY LP	9
SECTION 24	1
1 PADILLA, JESUS ETUX	7
SECTION 25	1
1 BRYAN, BONNY ETVIR	6
SECTION 26	1
1 SCHULZE, TIMOTHY ETUX	7
2 VLASATY, MICHAEL	7
3 KLAHN, JACK	10
SECTION 27	1
1 KLAHN, JACK	5

SECTION 28	
1 HILL, SCOTT ETUX	9
2 GRUNDMEIER, BONNIE	7
SECTION 29	1
1 LUTHE, KIRK ETUX	11
SECTION 30	1
1 LITTLEFIELD, DAWN	14
SECTION 31	1
1 MANGELS-DICK, TREVOR	5
2 MERTEN, PATRICK ETUX	6
3 MATHEWS, DAVID	15
4 HINDERAKER, LARRY	10
5 DIAMOND PARK FARM LLC	6
SECTION 32	1
1 JOHNSON, ANDY ETUX	5
SECTION 33	1
1 GRUNDMEIER, BONNIE	12
2 FREDERICKSEN, STACY ETVIR	7
3 HAMILTON, RUSS ETUX	6
4 MIDWEST WIRELESS COMMUNICATION	10
5 HALL, THOMAS ETUX	7
6 SHAW, CRAIG ETUX	10
SECTION 34	1
1 PETER, JASON	11
2 BLOCK, JENNIFER	8

SECTION 35	
1 GOSSMAN, MICHELLE	7
2 KLAHN, SAMUEL	9
SECTION 36	1
1 NESBITT, JARRED ETUX	7
2 CHURCHILL, BRIAN	8

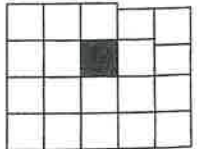

Soils Map

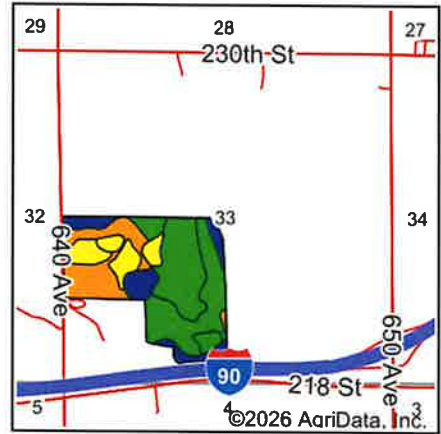
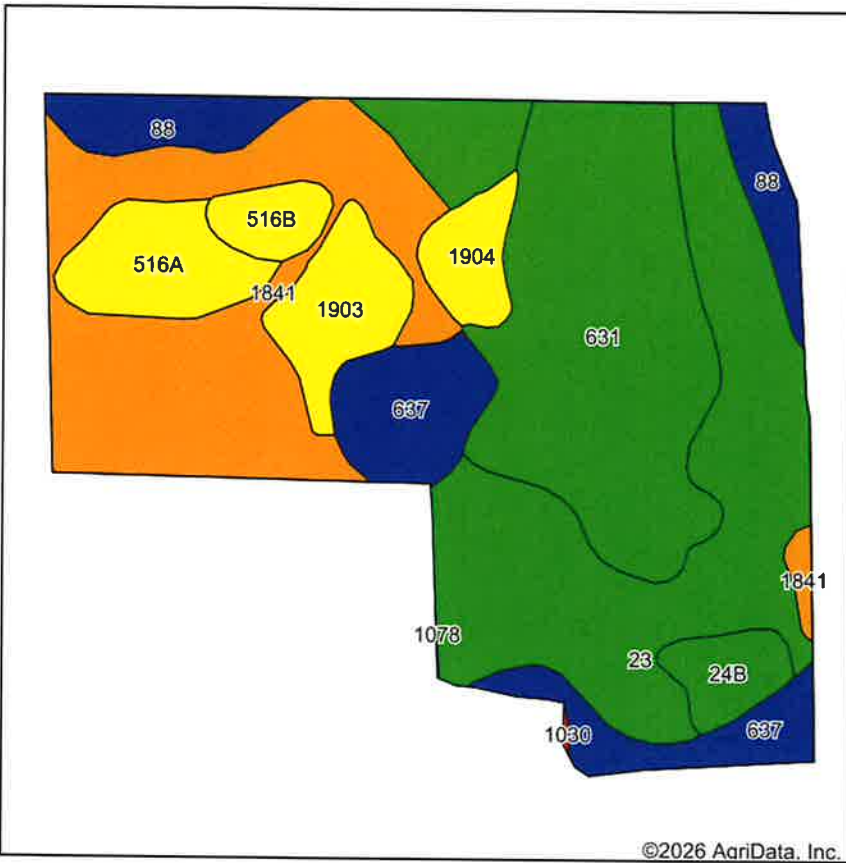

State: **Minnesota**
 County: **Mower**
 Location: **33-103N-16W**
 Township: **Dexter**
 Acres: **103.91**
 Date: **2/9/2026**



Soils data provided by USDA and NRCS.

Area Symbol: MN099, Soil Area Version: 21

Code	Soil Description	Acres	Percent of field	PI Legend	Non-Irr Class *c	Productivity Index	*n NCCPI Soybeans	
23	Skyberg silt loam, 0 to 3 percent slopes	28.14	27.1%		lw	95	65	
631	Oran silt loam, 1 to 4 percent slopes	23.21	22.3%		lw	95	63	
1841	Hayfield loam, loamy substratum	21.20	20.4%		lls	79	51	
637	Schley silt loam	9.02	8.7%		llw	84	70	
88	Clyde silty clay loam, 0 to 3 percent slopes	5.49	5.3%		llw	86	85	
516A	Dowagiac loam, 0 to 2 percent slopes	4.98	4.8%		lls	66	45	
1903	Udolpho silt loam, loamy substratum, swales	4.62	4.4%		llw	70	53	
1904	Udolpho silt loam, loamy substratum	2.70	2.6%		llw	70	54	
24B	Kasson silt loam, 1 to 4 percent slopes	2.51	2.4%		lle	95	63	
516B	Dowagiac loam, 2 to 6 percent slopes	2.04	2.0%		lle	64	45	
Weighted Average						1.55	86.5	*n 61

*n: The aggregation method is "Weighted Average using all components"

*c: Using Capabilities Class Dominant Condition Aggregation Method

Soils data provided by USDA and NRCS

